

# EXC<sub>d</sub>

Installation – Commissioning – Maintenance

20220217

## Accessories

### Mounting frame, EXCT 2

Mounting frame with rubber seal-fitted spigot connection.

### Mounting frame EXCT 3

Mounting frame with insertion joint dimensions for connection to spigots. The mounting frame has a larger inner diameter than the connecting duct component fitted with a spigot, e.g. a duct bend.

## Installation

Size of opening, see the dimension of the connecting duct. The mounting frame should be inserted into the connecting duct and fixed in position with blind rivets from the inside. Be careful when positioning the blind rivets so that they will not impede attaching the air valve in the mounting frame. Rotate the air valve into the bayonet mount of the mounting frame. See Figure 1.

## Commissioning

Rotate the inner cone clockwise (-) to increase the pressure drop and counterclockwise (+) to decrease it. Lock the position of the cone by tightening the lock nut on the rear side of the air valve.

The air valve can be commissioned by measuring the pressure or the airflow. For pressure measurement, use a so-called "measuring hook" and for airflow measurement use a commonly marketed airflow meter. See Figures 2 and 3.

The rated coefficient of performance (K-factor) is specified on the identification label of the product and in the relevant commissioning instructions at [www.swegon.com](http://www.swegon.com).

## Maintenance

The air valve can be cleaned, if necessary, using lukewarm water with dishwashing detergent added or by vacuum cleaning using a brush nozzle. The duct system can be reached for cleaning after the air valve has been rotated out of its mounting frame.

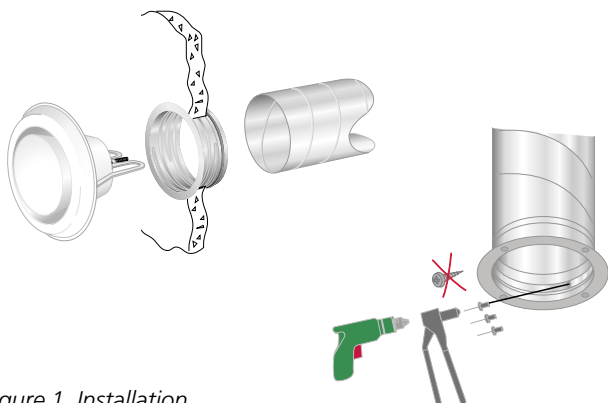

Figure 1. Installation.

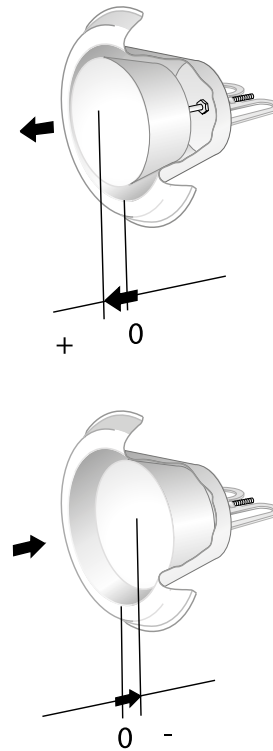

Figure 2. Commissioning.

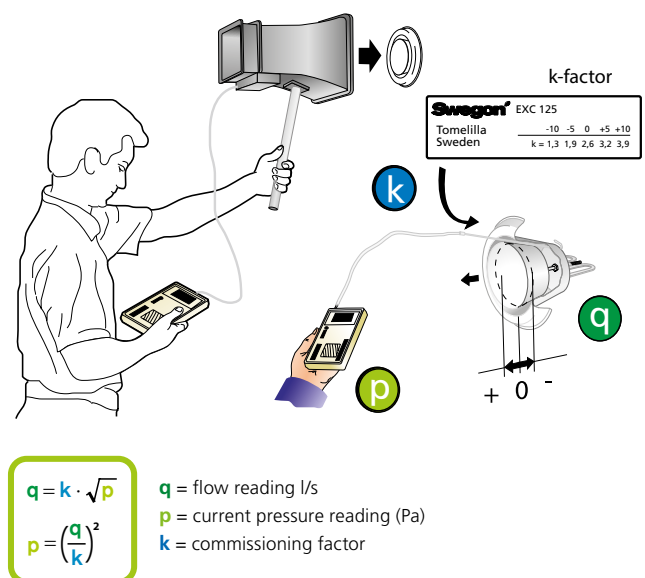

Figure 3. Commissioning.

# Dimensions and weights

## EXC

Size	A	B	ØD	Weight, g
100	70	16	142	265
125	85	16	173	350
160	85	16	205	475
200	108	16	252	700

## Mounting frame, EXCT 2

Size	ØD1	H	Weight, g
100	99	50	100
125	124	50	125
160	159	50	190
200	199	50	240

## Mounting frame, EXCT 3

Size	ØD2	H	Weight, g
100	101	55	100
125	126	55	125
160	161	55	190
200	201	55	240

## K-factor \*) (COP), EXC

Cone position	Size			
	100	125	160	200
-15	0.6	-	-	-
-12	0.8	-	-	-
-10	1.0	1.3	2.0	-
-5	1.4	1.9	2.8	-
-3	-	-	-	1.8
0	1.8	2.6	3.6	2.6
+5	2.3	3.2	4.5	3.8
+10	2.7	3.9	5.4	5.2
+15	-	-	6.2	6.4
+20	-	-	-	7.5
+25	-	-	-	8.6

\*) Measure with a test probe

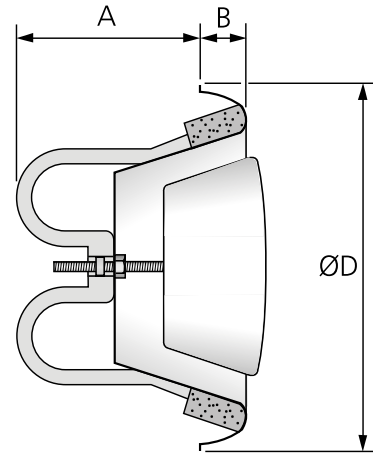

Figure 4. Extract air valve, EXC.

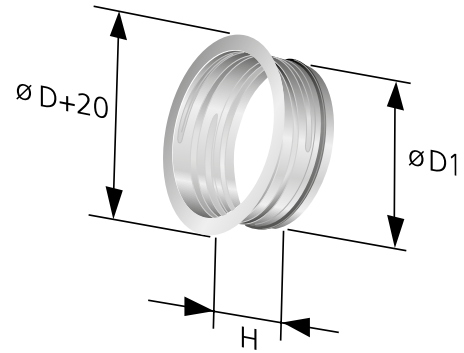

Figure 5. Mounting frame, EXCT 2.

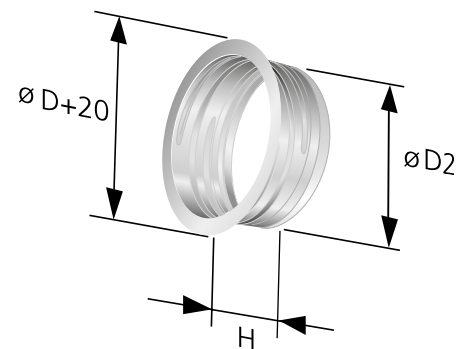

Figure 6. Mounting frame, EXCT 3. Mounting frame for connection direct against a spigot-equipped duct component, e.g. a duct bend.