



CASA AIR HEATER/COOLER

CASA air heater/cooler for heating and cooling



CASA air heater/cooler

Air cooler for waterborne cooling

If there is a network for cooling water in the property (e.g. cooling medium circuit) an air cooler can be installed in the supply air duct to produce comfort cooling in the home.

The air cooler is controlled automatically from the ventilation unit's CASA control system and settings can be changed using a CASA control panel. The height of the smallest air cooler (Ø160 mm) is only 255 mm, which permits installation in a suspended ceiling. SDCW250F is a fully insulated model + accompanying installation frame.

The delivery includes:

- air cooler
- SET connection module
- actuator and 3-way valve
- 24 V transformer
- requisite sensors and instructions

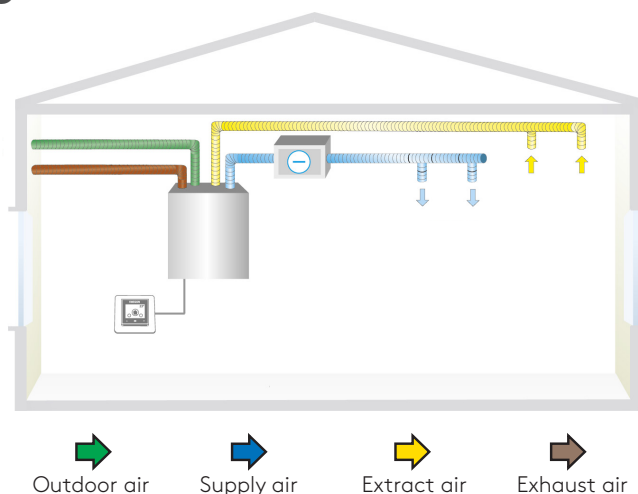

Air cooler for waterborne cooling																
Product code	Duct's Ø	W3	W4	W5	W9	R2	R3	R4-C	R5	R5-H	R7 R7-H	R9	R9-H	R15	R15-H	
SDCW160	160mm	○	○	○	-	○	○	○	○	○	-	-	-	-	-	
SDCW200	200mm	○	○	○	○	-	○	○	○	○	○	-	-	-	-	
SDCW250	250mm	-	○	○	○	-	-	○	○	-	○	○	-	○	-	
SDCW250F, insulated	250mm	-	○	○	○	-	-	○	○	-	○	○	-	○	-	
SDCW315	315mm	-	-	-	-	-	-	-	-	-	-	○	○	○	○	

○ Possible - Not possible

Air heater for waterborne heating

An air heater installed in the supply air duct can be used to utilise a waterborne heating system to heat the supply air. This is often more economical than using an electrically heated air heater.

The air heater is controlled automatically from the ventilation unit's CASA control system and settings can be changed using a CASA control panel. The height of the smallest air heaters (Ø125 and 160 mm) is only 255 mm, which permits installation in a suspended ceiling.

The delivery includes:

- air heater
- SET connection module
- actuator and 3-way valve
- 24 V transformer
- requisite sensors and instructions

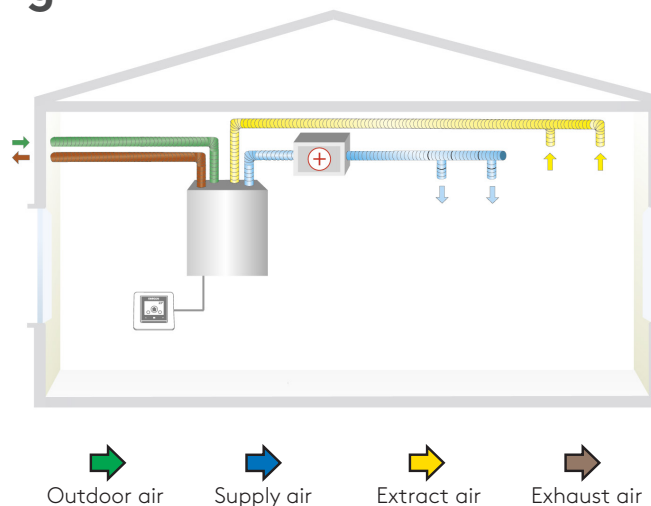
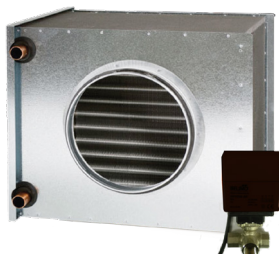

Air heater for waterborne heating															
Product code	Duct's Ø	W3	W4	W5	W9	R2	R3	R4-C	R5 R5-H	R7 R7-H	R9	R9-H	R15	R15-H	
SDHW125	125mm	○	-	-	-	○	○	-	-	-	-	-	-	-	
SDHW160	160mm	○	○	○	-	○	○	○	○	-	-	-	-	-	
SDHW200	200mm	-	○	○	○	-	-	○	○	○	-	-	-	-	
SDHW250	250mm	-	-	-	○	-	-	-	-	○	○	-	○	-	
SDHW315	315mm	-	-	-	-	-	-	-	-	-	○	○	○	○	

○ Possible - Not possible

Air heater/cooler in combination with ground source heat pump

An air heater/cooler can be installed in the outdoor air duct in a property fitted with a ground source heat pump. It then utilises the heating/cooling medium to heat the inflowing air during the winter and to cool it during the summer.

In the winter the air heater/cooler heats the air taken in and ensures that the ventilation unit operates with the greatest efficiency even in extreme cold. In the summer, the medium in the ground circuit is used to cool the building. The control technology in CASA means that the air heater/cooler is automatically utilised optimally all year round.

The delivery includes:

- fully insulated unit
- wall mounting bracket/ceiling mounting frame
- an efficient 4-row air cooler suitable for cooling medium
- SET connection module
- wide-mesh filter
- requisite sensors and instructions
- drip tray for condensate: condensation water outlet with 3/8" male thread

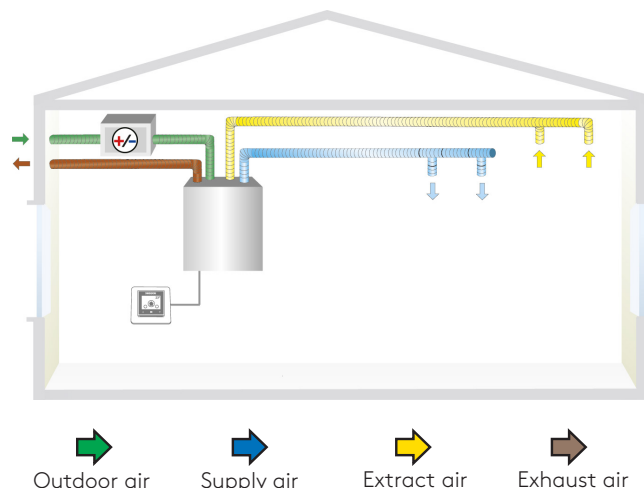

Waterborne air heater/cooler in combination with ground source heat pump													
Product code	Duct's Ø	W3	W4	W5	W9	R2	R3	R4-C	R5 R5-H	R7 R7-H	R9 R9-H	R15 R15-H	
SDHW250F	250mm	○	○	○	○	○	○	○	○	○	-	-	

○ Possible - Not possible

Electric air heater for pre-/reheating, for installation in ducts

Used for pre-heating

Guarantees continuous ventilation during very cold conditions and permits balancing functions (fireplace function/function for cooker hood) in air handling units without a built-in air heater for pre-heating. An FLK-filter must be installed in the duct in front of the preheater.

Used for reheating

Helps to reach the desired supply air temperature during very cold conditions, when the output of the heat exchanger is not sufficient to heat the air.

The delivery includes:

- SET connection module
- electric air heaters
- requisite sensors and instructions

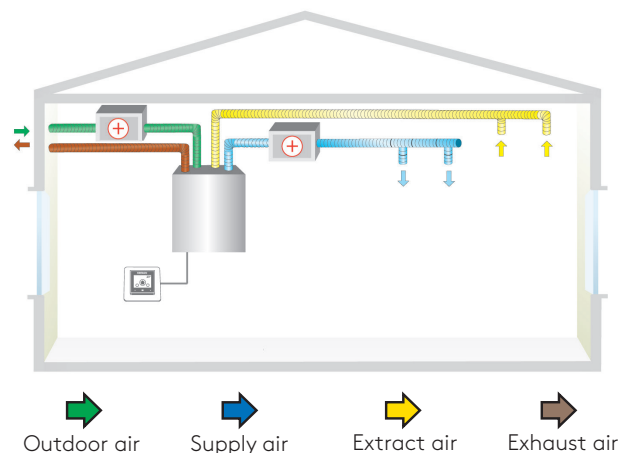

Electric air heater for pre-/reheating, for installation in ducts													
Product code	Duct's Ø	Kanal-filter	W3	W4	W5	W9	R2	R3	R4-C	R5 R5-H	R7 R7-H	R9 R9-H	R15 R15-H
SDHE125-1T (1200W)	125mm	FLK12	○	-	-	-	○	○	-	-	-	-	-
SDHE160-1T (1200W)	160mm	FLK16	○	○	○	-	○	○	○	○	-	-	-
SDHE200-1T (1200W)	200mm	FLK20	-	○	○	○	-	-	○	○	○	-	-
SDHE250-1T (1200W)	250mm	FLK25	-	-	-	○	-	-	-	-	○	○	○
SDHE250-2T (2000W)	250mm	FLK25	-	-	-	○	-	-	-	-	○	○	○
SDHE250-3T (3000W)	250mm	FLK25	-	-	-	○	-	-	-	-	-	○	○
SDHE315-1T (1200W)	315mm	FLK31	-	-	-	-	-	-	-	-	-	○	○
SDHE315-2T (2000W)	315mm	FLK31	-	-	-	-	-	-	-	-	-	○	○
SDHE315-3T (3000W)	315mm	FLK31	-	-	-	-	-	-	-	-	-	-	○
SDHE315-5T (4500W)	315mm	FLK31	-	-	-	-	-	-	-	-	-	-	○

○ Possible - Not possible

Dimensions

Air cooler for waterborne cooling, SDCW

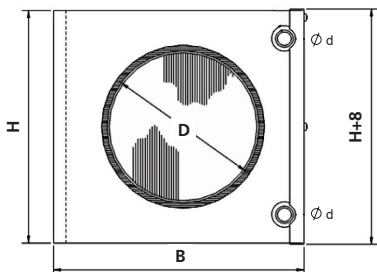

Leave at least 40 cm service space in front of the door.

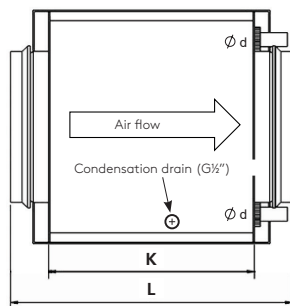

Model	H (mm)	B (mm)	D (mm)	d (mm)	K (mm)	L (mm)	Weight (kg)	Coil inside volume (l)
SDCW 160	255	326	160	10	280	360	6	0,4
SDCW 200	330	411	200	22	280	360	9	0,7
SDCW 250	405	486	250	22	280	360	11	1,1
SDCW 315	504	560	315	22	280	360	15	1,61

SDCW250F is a fully insulated model + accompanying installation frame.

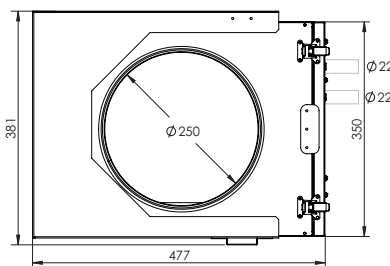

Leave at least 50 cm service space in front of the door.

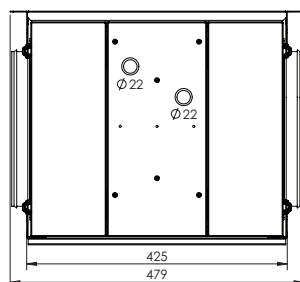

Model	H (mm)	B (mm)	D (mm)	d (mm)	K (mm)	L (mm)
Ø 250 SDCW250F is a fully insulated model + accompanying installation frame.	381	477	250	22	425	479

Air heater for waterborne heating, SDHW

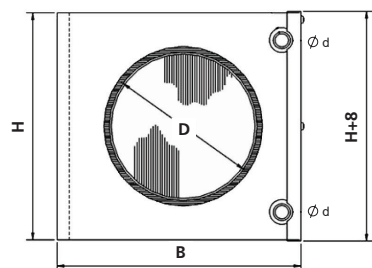

Leave at least 40 cm service space in front of the door.

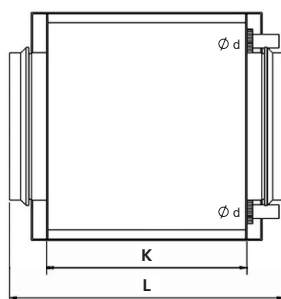

Model	H (mm)	B (mm)	D (mm)	d (mm)	K (mm)	L (mm)	Weight (kg)	Coil inside volume (l)
SDHW 125	255	326	125	10	280	350	5,2	0,4
SDHW 160	255	326	160	10	280	360	5,4	0,4
SDHW 200	330	411	200	22	280	360	8,2	0,7
SDHW 250	330	411	250	22	280	360	7,7	0,45
SDHW 315	405	486	315	22	280	360	9,9	0,7

Waterborne air heater/cooler in combination with ground source heat pump

SDCW250F is a fully insulated model + accompanying installation frame.

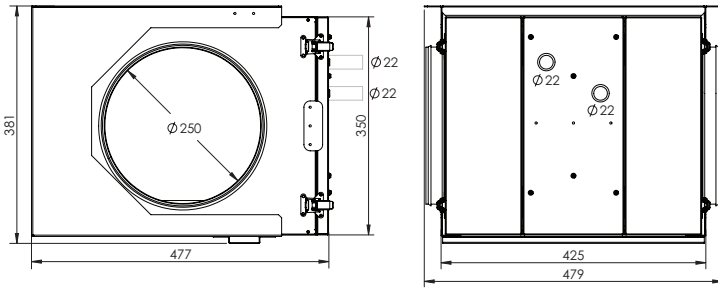

Leave at least 50 cm service space in front of the door.

Model	H (mm)	B (mm)	D (mm)	d (mm)	K (mm)	L (mm)
Ø 250 SDCW250F is a fully insulated model + accompanying installation frame.	381	477	450	22	425	479

Electric air heater for pre-/reheating, for installation in ducts, SDHE

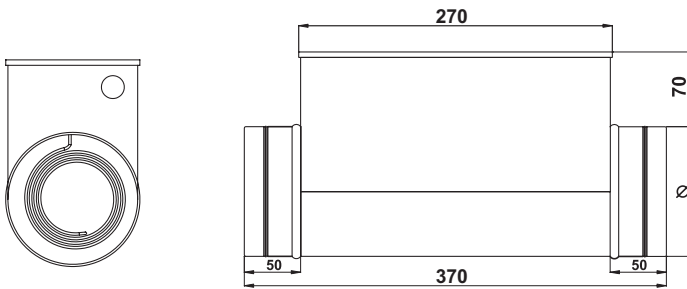

Duct's Ø*	125	160	200	250	315

Duct filter in combination with an air heater for pre-heating, FLK

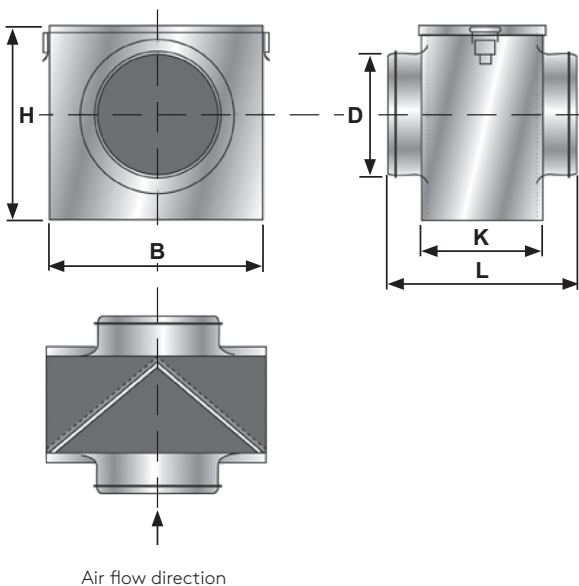

	FLK12	FLK16	FLK20	FLK25	FLK31
H:	205	235	275	325	390
B:	215	255	315	365	425
D:	125	160	200	250	315
K:	140	155	180	230	320
L:	252	267	302	352	452

Feel good **inside**

